

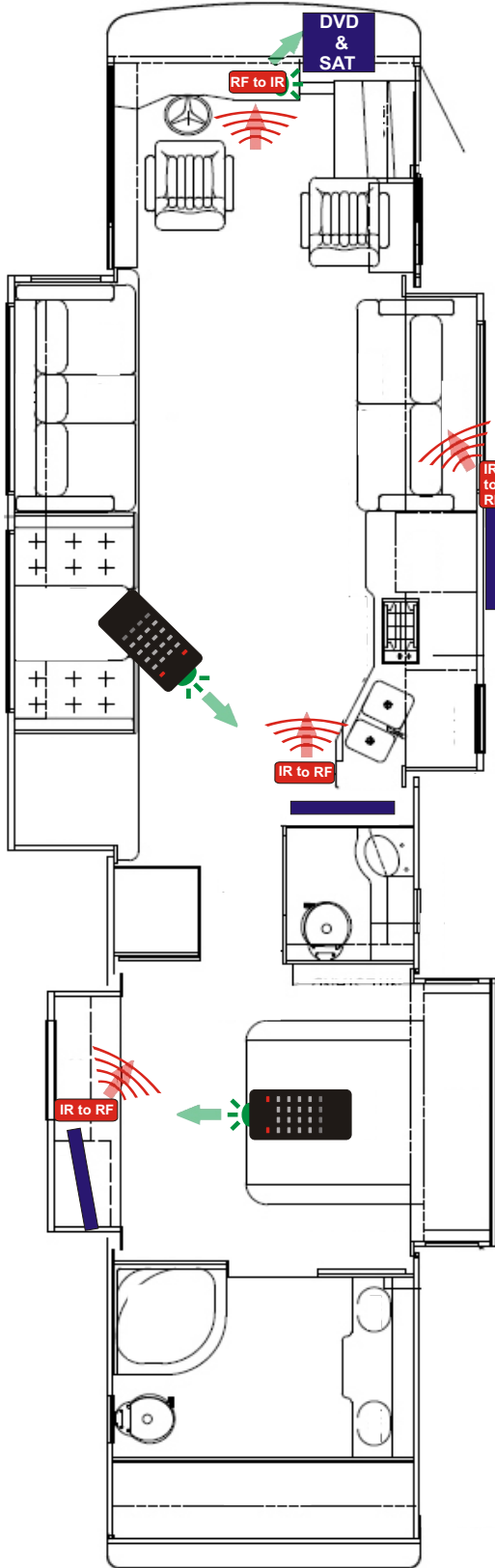

Spyder Controls Corporation

Defining Innovation and Reliability in System Control

WIRELESS INFRA-RED (IR) REPEATER SYSTEM



DESCRIPTION: The wireless IR Repeater system allows Infra-Red (IR) signals from Audio / Video (A/V) remote controls to be received in one location and wirelessly transmitted to another location, where the IR signal is then re-emitted. The system uses proven Radio Frequency (RF) technology that is used in numerous automotive security / alarm systems, ensuring reliable operation.



wlRe Repeater (Emitter)

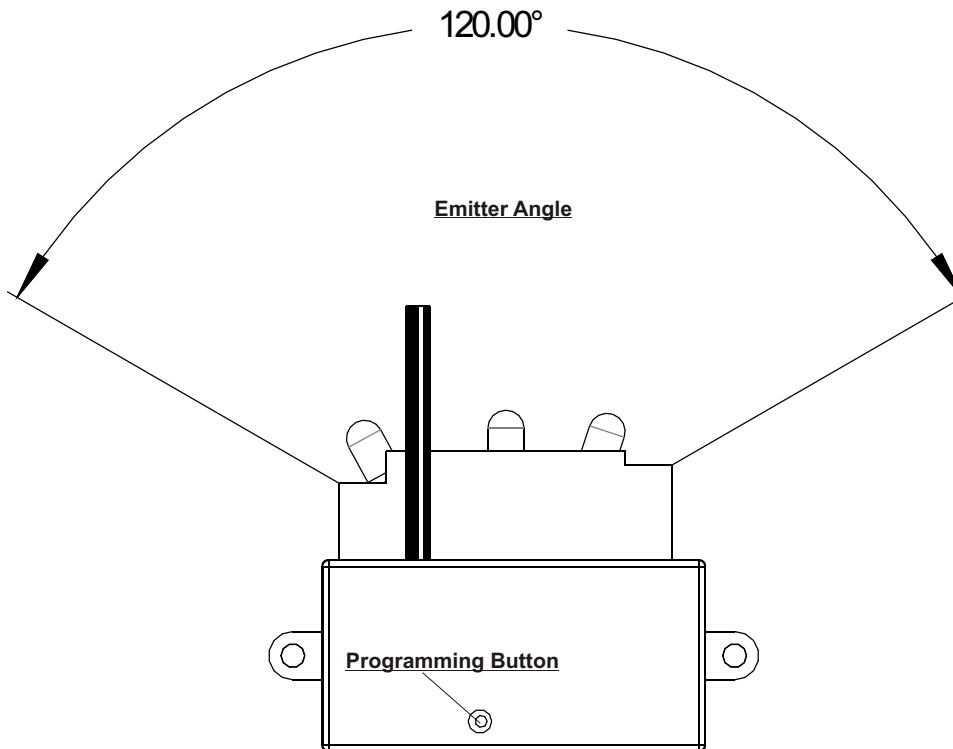
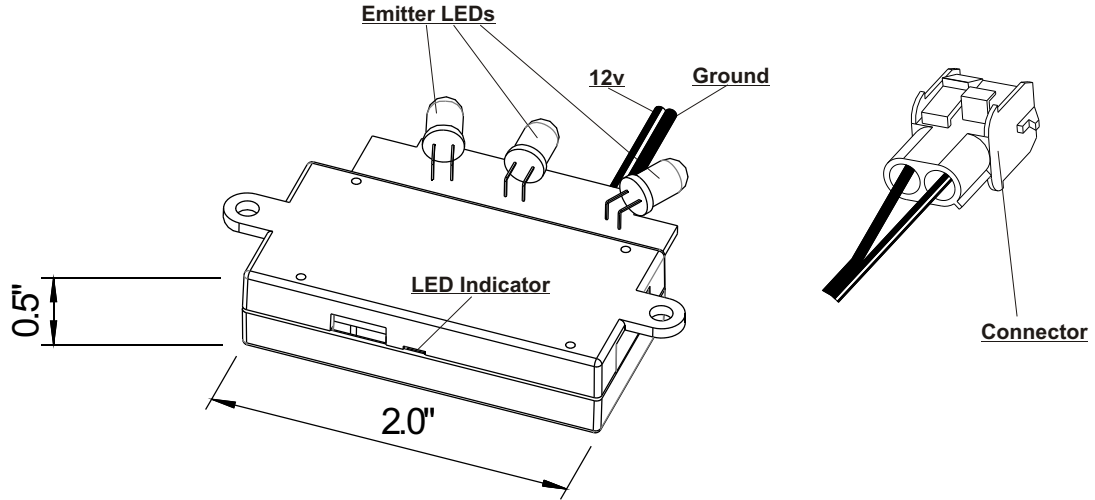



WIRe Repeater (Receiver)

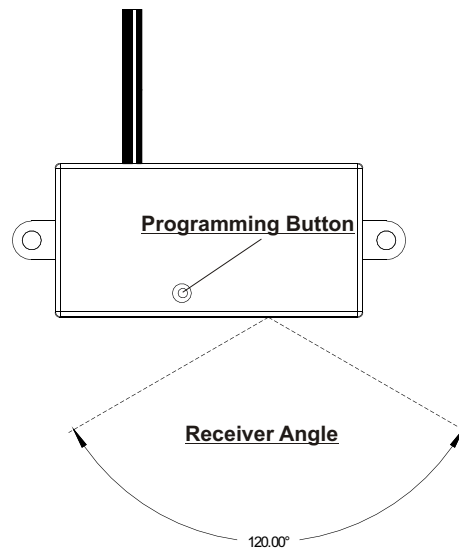
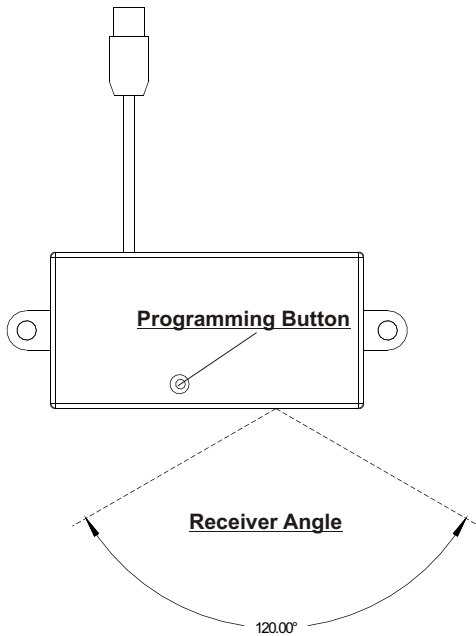
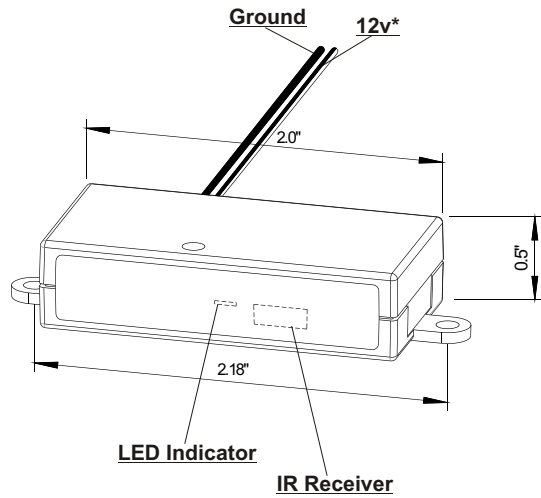
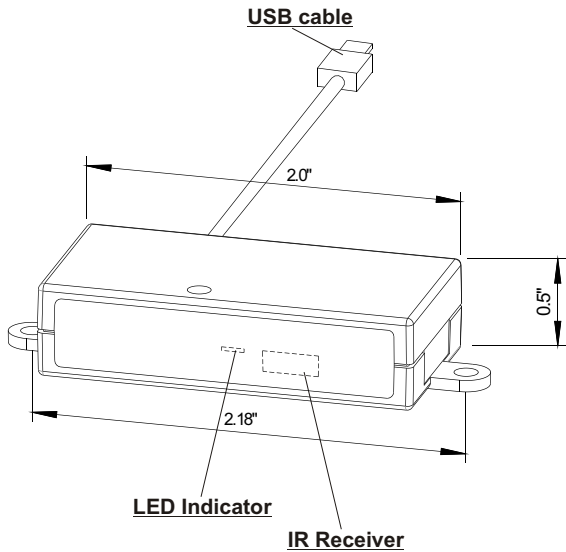

Operational Voltage Range: 5 to 16 VDC

RF Characteristics:

- ISM band: 900MHz;
- Base frequency: 903MHz;
- Channel spacing: 199.951172MHz;
- Over-the-air data rate: 249.756 Kbs;
- TX power: 0 dBm;
- Number of channels: 52.



WIRE Channel Settings

To view an instructional video clearly and visually outlining these steps that are described below, please visit our website at www.spydercontrols.com. Go to the "CUSTOMERS" tab and log in.

Username: Tiffin

Password: Motorhomes

Click on the Spyder IR Repeater System view video link.

1. Set one of the IR devices into RF TRANSMIT mode by pushing the program button ONE time (this would usually be done on the EMITTER device inside the DVD cabinet). The RED LED will begin to flash slowly (1 time per second).

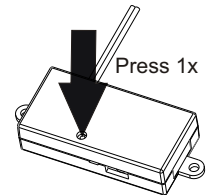

2. Go to one of the RECEIVER devices located at the TV (make sure the TV is turned on) and put it into LEARN mode by quickly pushing the program button TWO times. The RED LED will begin to flash quickly (2 times per second).

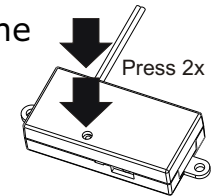

3. Once the 'New' device has paired with the 'Transmitting' device, the LED on the 'New' device will stop flashing. The 'Pairing' process can take up to 1 minute.

4. Repeat step #2 for each of the RECEIVER devices located at the TV's (make sure each TV is ON).

5. To take the device at the DVD cabinet out of RF TRANSMIT mode, push the program button once. The RED LED on the EMITTER will stop flashing.

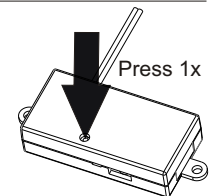

6. Test the IR Repeater system using the DVD/Blue-Ray remote control to operate the DVD player.

Note:

When in Listening Mode, a WIRE will only act on learn packets that contain its traffic-type byte.

**The wIRe devices operate on 52 unique RF channels. When a wIRe device enters Listen Mode, it begins with its last stored RF channel and 'listens' for a matching RF signal for 1 second. If no matching signal is received within 1 second, the wIRe device increments up to the next channel and listens for 1 second and so on until a matching RF signal is received. It can take up to 52 seconds for a wIRe device to find a matching signal..