



7in LCD Screen Guide

2023 ALLEGRO
RED 360/BREEZE/BAY



USER GUIDE - 7in LCD SCREEN

Contents

HOME PAGE 5

- Figure 1 (Lighting Section) 5
- Figure 2 (Climate Section) 5
- Figure 3 (Tank Section)..... 5
- Figure 4 (Power Section) 5
- 1. Page Designation..... 6
- 2. Active Fault Icon..... 6
- 3. Home Button..... 6
- 4. Clock..... 6

LIGHTING PAGE 7

- Figure 1 (Main)..... 7
- Figure 2 (Light Master)..... 7
- Figure 3 (Entry & Exterior) 7
- Figure 4 (Bed & Bath)..... 7

CLIMATE PAGE 8

- Figure 1 (Zone + Ambient Temperature) 8
- Figure 2 (Floor Heat) 8
- Figure 3 (HVAC Mode Select)..... 8
- Figure 4 (Fan Control) 8
- Figure 5 (Aqua-Hot Control)..... 9
- Figure 6 (Temperature Set Point) 9
- Figure 7 (HVAC Status) 9

Power Page 10

- Figure 1 (Battery Charge Time) 10

Figure 2 (Battery Voltage and Merge)	10
Figure 3 (Generator Control)	10
Figure 4 (AGS)	10
Figure 7 (Shore Power)	10
Mechanical.....	11
Figure 1 (Fan On / Off)	11
Figure 2 (Fan Location).....	11
Figure 3 (Fan Lid Up/Down)	11
Figure 4 (Fan Intake/Exhaust Maxxfan Only).....	11
Figure 5 (Fan Speed Maxxfan Only)	11
Figure 6 (TV Lift Up/Down)	11
Figure 7 (Ceiling Fan Control).....	12
SLIDE PAGE.....	13
Figure 1 (Slide Extend/Retract)	13
Figure 2 (Slide Run Requirements Status)	13
Figure 3 (Emergency Front Slide Control).....	13
Figure 4 (Slide Run Error)	13
SETTINGS PAGE	14
Figure 1 (Temperature Unit Toggle)	14
Figure 2 (Screen Brightness Adjust).....	14
Figure 3 (Screen Settings)	14
Figure 4 (Diagnostics).....	14
Figure 5 (Model and Config Info)	14
Figure 6 (Coach Model Select)	14
Figure 7 (Wireless Settings)	14
Figure 8 (Clock Setting)	14
Figure 9 (System Update).....	15
Faults Page	15
Figure 1 (Active Fault List).....	15
Figure 2 (Diagnostic Page Select).....	15
Figure 3 (Fault Warning)	15
GLOSSARY.....	16
General function of screen buttons and indicators.....	16

HOW TO REMOVE A NETWORK CABLE 16
..... 17
NET LED Functions 17
SUPPORT 17

HOME PAGE

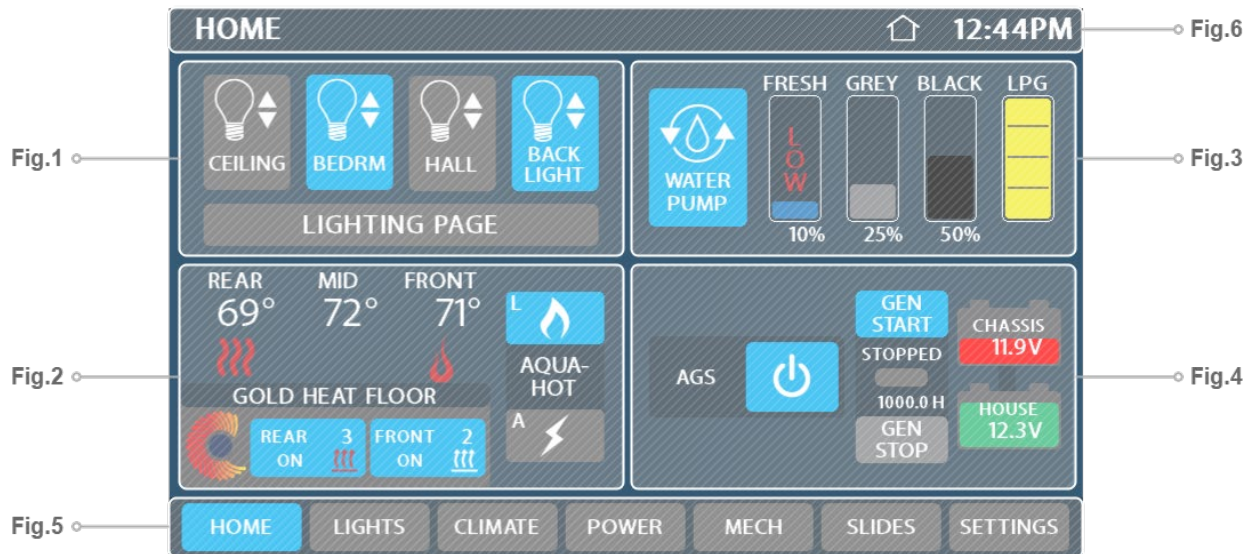

Figure 1 (Lighting Section)

- This section allows you to have quick control over frequently used lights in the coach.

Figure 2 (Climate Section)

- This section displays climate information and current heating, cooling, and fan status. Press on this box to quickly jump to the climate page. If a Truma water heater is present, no water heater control will be displayed on the Spyder LCD as shown above. If a Truma water heat is not present gas and electric water heat will be displayed here. Note: if the gas icon is red a fault has occurred with the water heater.

Figure 3 (Tank Section)

- This section displays tank levels. The graph will indicate the levels of each tank and will also provide you with a warning when the tanks are low for fresh or full for grey and black.

Figure 4 (Power Section)

- This section displays power information for the coach. This includes house and chassis battery status. Press on this box to quickly jump to the power page. The generator status and hours are also displayed here.

Figure 5 (Bottom Ribbon)

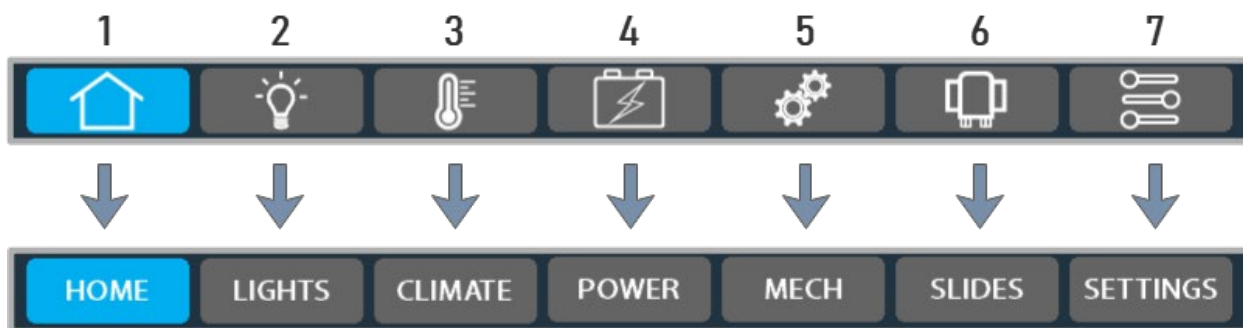

1. Home Page
2. Lights Page
3. Climate Page
4. Power Page
5. Mechanical Page
6. Slides Page
7. Settings Page

[Ribbon Appearance]

The bar may be changed from icons to text (shown above). This is up to the owner's preference.

To change the bar style, go to.

Settings > Screen Settings > Ribbon Options

Figure 6 (Top Ribbon)



1. Page Designation
 - This section displays your current page.
2. Active Fault Icon
 - This icon will only appear when a fault is active. If this is visible on any screen, press it to bring you to the fault page.
3. Home Button
 - Press on this icon to return to the home page.
4. Clock
 - To adjust the clock, tap on the current time, this will take you to the settings page where you will be able to adjust the clock.

LIGHTING PAGE

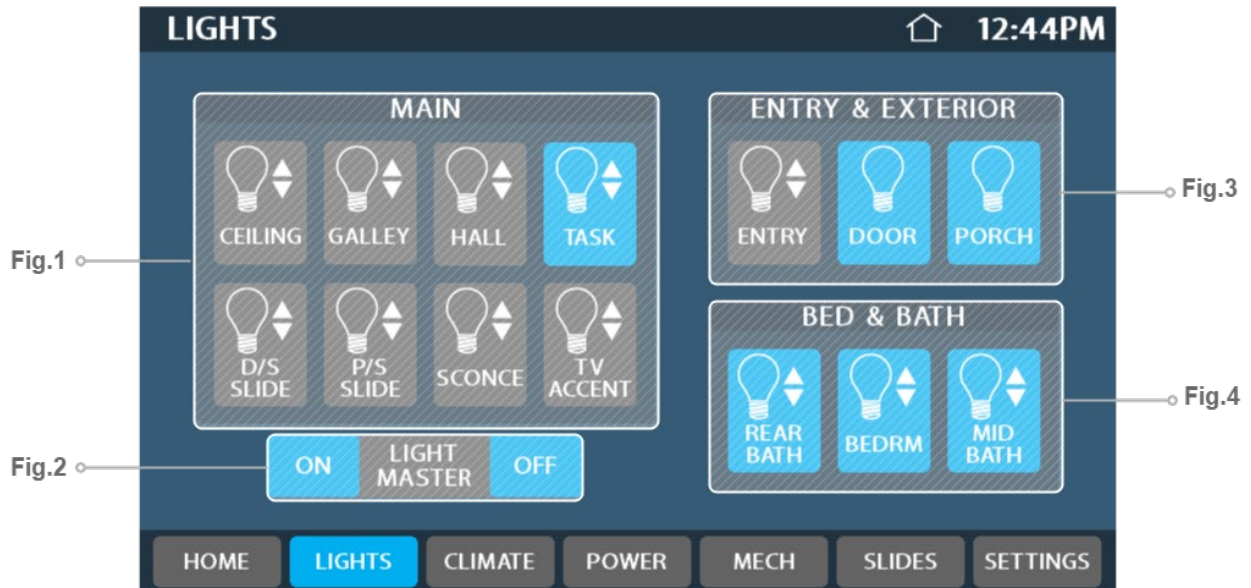

Figure 1 (Main)

- This section allows control over your main interior lights. Any lights that can dim will contain two arrows beside the light. Holding this light button will bring up a dimming slider. Drag the slider up and down to set the desired brightness level.

The light will remember its dimmed value until light master is held on. When light master is held on all previously dimmed lights will return to full brightness.

Figure 2 (Light Master)

- Press light master off to turn off any lights that are currently on in the coach. Press light master on to turn these same lights back on. Hold light master on to turn on all interior lights at full brightness.

Figure 3 (Entry & Exterior)

- This section allows control of your entry and exterior lights.

Figure 4 (Bed & Bath)

- This section allows control of your bed and bath lights.

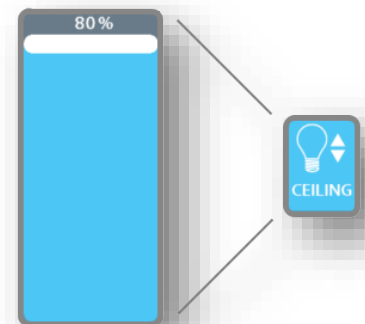

CLIMATE PAGE

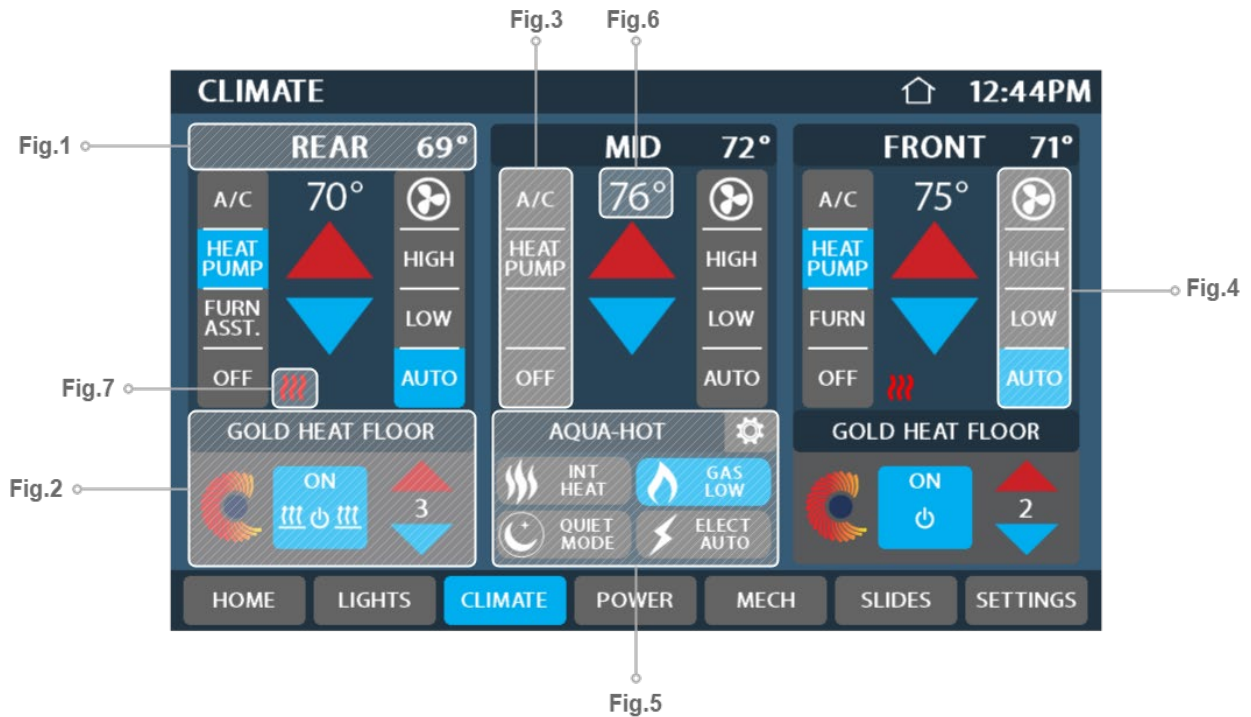

Figure 1 (Zone + Ambient Temperature)

- This section displays the location of the air-conditioning unit and the ambient temperature in the zone.

Figure 2 (Floor Heat)

- This section allows control over the floor heat. The 3 arrows rising indicate a heating status, meaning the floor is currently heating. Once the floor heat reaches temperatures it will enter standby mode. Temperature settings of 1-5 are available with 1 being the coolest and 5 being the warmest.

Figure 3 (HVAC Mode Select)

- This section provides control over your HVAC loads. Press an icon to activate it. AC loads will flash while they check with the EMS for available power. For safety and the longevity of the HVAC system, most HVAC loads have delays before turning on and off. Zones cannot have conflicting modes. Hence setting any AC unit to heating while the rest are in cooling will turn off all AC's and vice versa.

Figure 4 (Fan Control)

- This section allows control of the AC fan. When you run the AC in cooling mode you will be able to select either Fan High, Fan Low, or Auto. Auto mode will control the fan for you choosing the best time to switch from High to Low. It is recommended having the fan on high or auto when cooling the coach with the AC. Running the fan on low with the AC on can cause the AC to prematurely freeze up.

Climate Page Continued

Figure 5 (Aqua-Hot Control)

- This section allows control over the heating mode for the water heater/Aqua-Hot. Electric, gas or both can be selected to heat the water system.
 - Once the electric icon is pressed it will flash until the system has verified there is sufficient power for the electric heat.
 - The diesel will flash if the burner has failed to ignite. Tap the button off then back on to try again. If the burner still does not ignite contact the water heater manufacturer for support.
 -

Figure 6 (Temperature Set Point)

- This section allows control over the HVAC set point in the coach. To heat the coach with your furnace or heat pumps you must first select heat pump or furnace then set your set point above the current ambient temperature (Fig.1) To cool the coach you must select AC then set your set point below the ambient temperature (Fig.1)

Figure 7 (HVAC Status)

- For safety and longevity of the HVAC system delays are put in place between starting and stopping HVAC loads. These icons display the status of the HVAC system.



[HVAC Icons]

- | | |
|---------------------------------|---|
| 1. Furnace: Off (Grey) On (Red) | 3. Fan Status: Fan High (H) Fan Low (L) Fan Off (No Letter) |
| 2. AC: Off (Grey) On (Blue) | 4. Heat Pump: Off (Grey) On (Red) |

Power Page

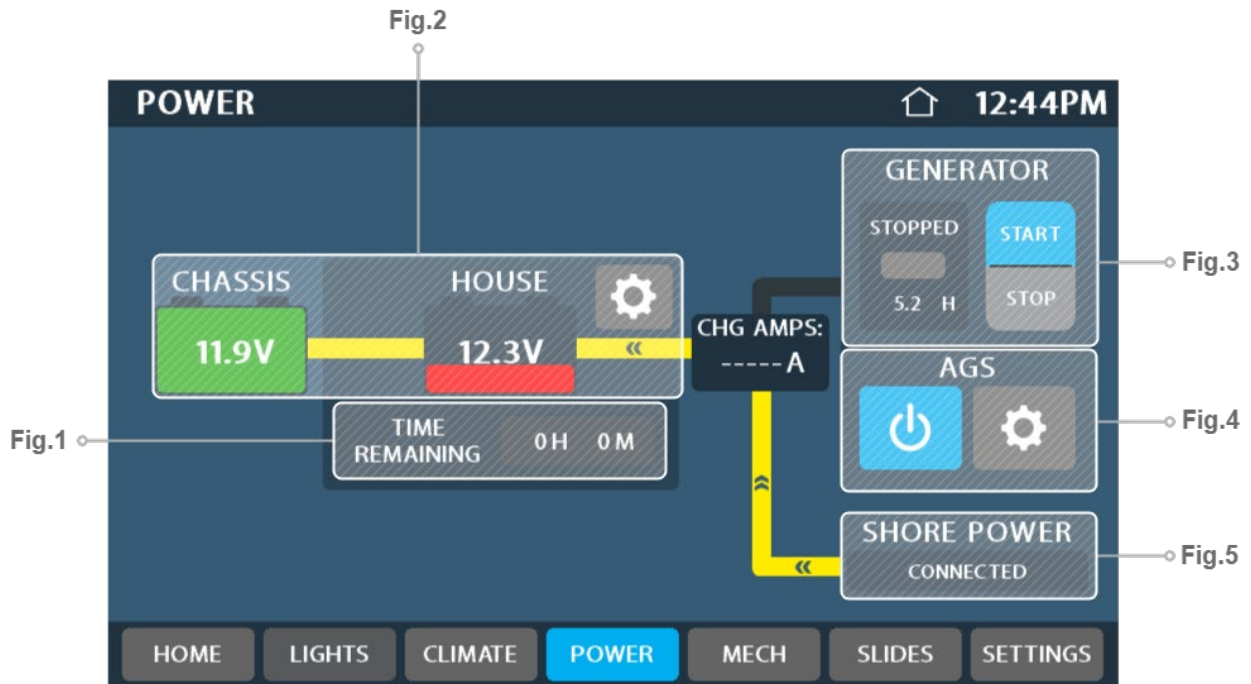

Figure 1 (Battery Charge Time)

- This section displays the time remaining until your batteries are fully charged.

Figure 2 (Battery Voltage and Merge)

Here you will be able to see your current battery voltage for your house and chassis batteries. When the batteries are merged the line between them will turn yellow. Press on the gear icon to open your TruState settings, this will give you a detailed readout of your battery information.

Figure 3 (Generator Control)

- Press the start or stop buttons to turn your generator on or off. When starting the button will flash blue until the generator has started.

Figure 4 (AGS)

- This button allows you to turn your AGS (Automatic Generator Start) on or off. Press the gear icon (settings) to access the AGS setting page, from the settings page you will be able to choose when AGS will start your generator. You can also set up quiet time options if you are in a park with specific generator running hours.

Figure 7 (Shore Power)

- This will display whether shore power is connected or disconnected.

Mechanical



Figure 1 (Fan On / Off)

- Press this to toggle the selected fan on and off.

Figure 2 (Fan Location)

- This banner indicates the location of the vent fan controlled by the buttons below (if applicable).

Figure 3 (Fan Lid Up/Down)

- Press this to raise or lower the vent fan lid. To select an exact vent fan lid position, press and hold the up or down arrow on the vent fan. Once you have reached the desired level, release the button.

Figure 4 (Fan Intake/Exhaust Maxxfan Only)

- If this button appears the fan direction can be changed from intake to exhaust, please note not all locations have a direction option. This feature is only available with Maxxfans.

Figure 5 (Fan Speed Maxxfan Only)

- Press the + icon to increase the fan speed and the - icon to decrease the fan speed. This feature is only available with Maxxfans.

Figure 6 (TV Lift Up/Down)

- Press the TV lift button to raise the TV lift. **Press and Hold** the TV lift down button to lower the TV.

Please note a press and hold is required to lower a TV Lift, this is to ensure that nothing is pinched when the TV Lift is lowered. The bed lift can be actuated from the bed lift button.

Figure 7 (Ceiling Fan Control)

- This button allows control of the ceiling fan (if applicable). Press the corresponding buttons to select fan speed.

SLIDE PAGE

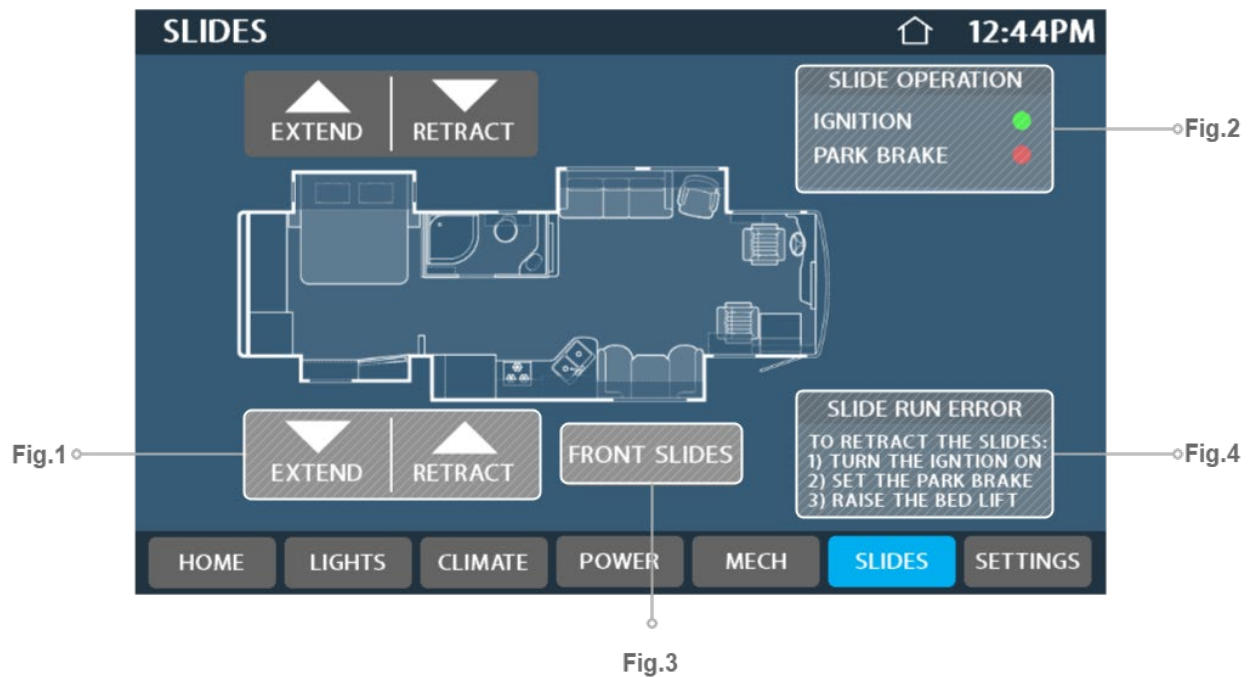

Figure 1 (Slide Extend/Retract)

- Pressing these buttons will extend and retract your slides if the requirements shown in Fig.2 are met.

Figure 2 (Slide Run Requirements Status)

- This section shows the status of ignition, park brake and bed lift (if applicable). All must be green before the slides can retract or extend.

Figure 3 (Emergency Front Slide Control)

- Press this to control you front slides if they are not operable from the rocker switches on the seat. Please try to use the rocker switches on the seat before using these buttons. Follow the on-screen directions to safely extend or retract your front slides

Figure 4 (Slide Run Error)

- This warning will appear when you try to run your slides if one or more of the following conditions are not met
 - The ignition is not on
 - The park brake is not set
 - The bed lift is not raised (if applicable)

SETTINGS PAGE



Figure 1 (Temperature Unit Toggle)

- Press this to toggle temperature units between Celsius and Fahrenheit

Figure 2 (Screen Brightness Adjust)

- Drag the slider to increase and decrease screen brightness

Figure 3 (Screen Settings)

- Press this to access screen timeout, default screen and screen theme adjustment.

Figure 4 (Diagnostics)

- Press here to jump to the diagnostic pages (These are generally only used by technicians when troubleshooting)

Figure 5 (Model and Config Info)

- Spyder Controls may ask you for this information when troubleshooting

Figure 6 (Coach Model Select)

- This displays your coach model. If this is set incorrectly, please contact Spyder Controls.

Figure 7 (Wireless Settings)

- Press this to access the wireless settings for your coach. You can pair a wireless switch from this page.

Figure 8 (Clock Setting)

- This displays the current time, to adjust the clock use the arrows to adjust the hours and minutes.

Figure 9 (System Update)

- When you press this button, it will scan the system to see if any modules need to be updated.

Faults Page

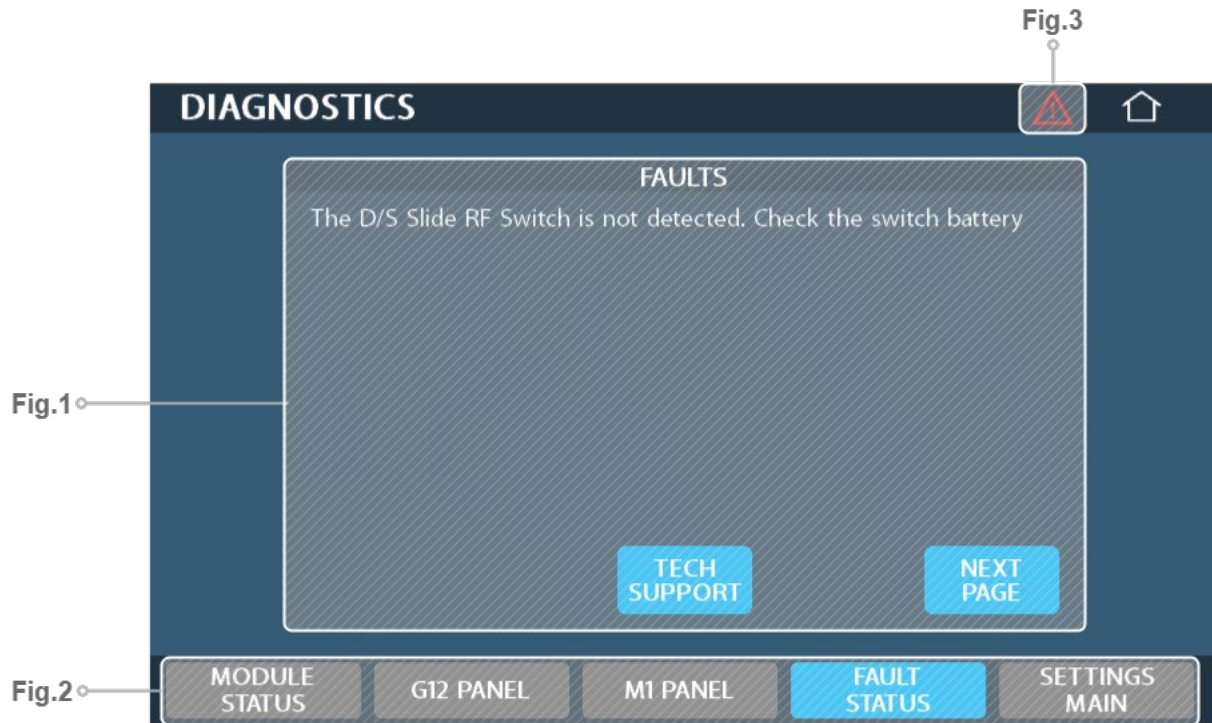

Figure 1 (Active Fault List)

- This list will show any active fault in the coach. If a fault appears here, please contact Spyder Controls for trouble shooting. Press the tech support button to view Spyder Controls support information.

Figure 2 (Diagnostic Page Select)

- Use this to navigate between diagnostic pages. Please note these pages are generally only used to troubleshoot coach problems.

Figure 3 (Fault Warning)

- If this is visible on any screen, press it to bring you to the fault page. This will only appear when a fault is active

GLOSSARY

General function of screen buttons and indicators

- Screen buttons will generally be grey when disabled and blue when enabled.
- On diagnostic pages a green dot indicates the load is on while grey indicates a load is off

Load – Any electrical device controlled by the Spyder Multiplex System (i.e., Bathroom Lights, Air conditioner compressor, Water Pump, etc)

Constant Loads – Electrical devices that use constant power to function though they may not user power all the time (i.e., Dishwash, Fireplace, Washing Machine)

HVAC –Heating, Ventilation and Air Conditioning

HOW TO REMOVE A NETWORK CABLE

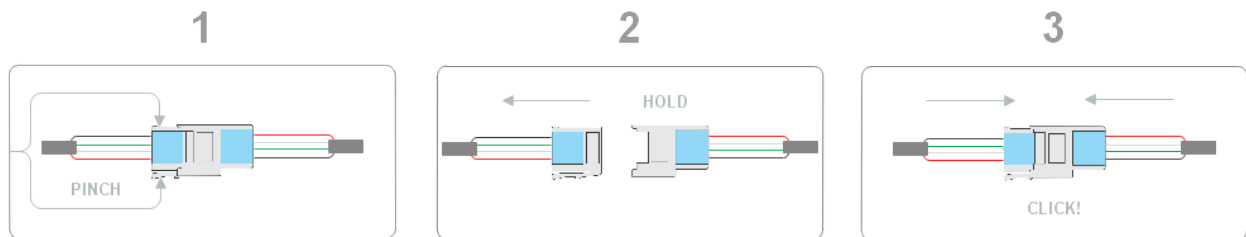

To remove a network clamp from a socket or another type of connector follow three simple steps

1. Pinch the small black clamp
2. While pinching the plug and holding the socket/connector, pull the plug
3. To reconnect push the plug end into the socket/connector until you hear an audible click

NET LED STATUS

NETWORK STATUS LED INDICATOR

	SOLID GREEN - Device is connected to network and communicating properly
	LED OFF - Device has no power or has failed completely
	SOLID RED - Device has gone offline and is not connected to the network
	FAST FLASHING GREEN (4 times / sec) - Device is attempting to make initial connection and claim a network address
	SLOW FLASHING GREEN (1 times / sec) - Device is online but has not seen a valid network message in 5 seconds
	ALTERNATING RED & ORANGE - Device has gone offline and is attempting to re-connect (within 30 seconds)
	ALTERNATING GREEN & ORANGE - Device is currently online but has gone offline 2 or more times

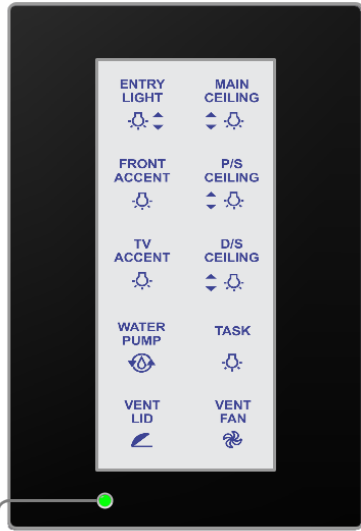

NET LED is located on back of switch panel

NET LED Functions

The NET LED (Network LED) is used to identify the network status of a module (i.e., Switch panel, LCD screen). NET LEDs are useful for troubleshooting and identifying issues with a coach.

A chart is provided on the PREVIOUS page to help break down what the various states of the NET LED mean.

SUPPORT

If you have any questions or concerns about your Spyder Controls Multiplex System, please contact Spyder Controls toll free at (866) 919-9092 or reach us by email at info@spydercontrols.com.

For service manuals and helpful videos on your coach please visit Spydercontrols.com press "login" then enter the following information into the username and password fields

Username: Tiffin

Password: Motorhomes



Use your phone camera or QR code scanner to view our website